

PEDERNALES COMPLETE STREETS

Myron Bañez | Master of City Planning Candidate
University of Pennsylvania Weitzman School of Design

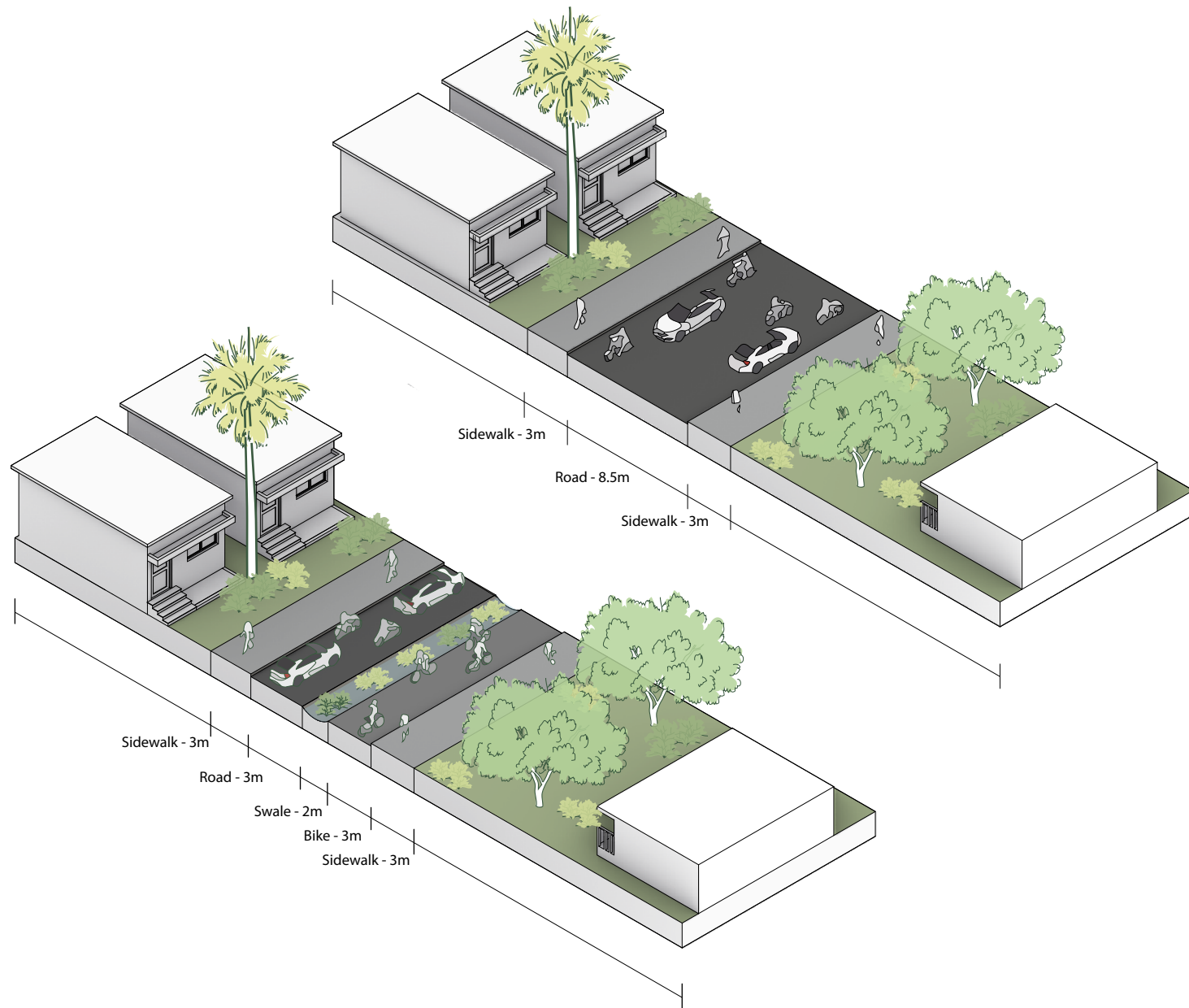

TPOLOGY 1: Road Diet Along Major Roads

Implementing a one way street provides ample room for a two way bike lane with a bioswale to serve as a buffer and mechanism for water management and flood resilience.

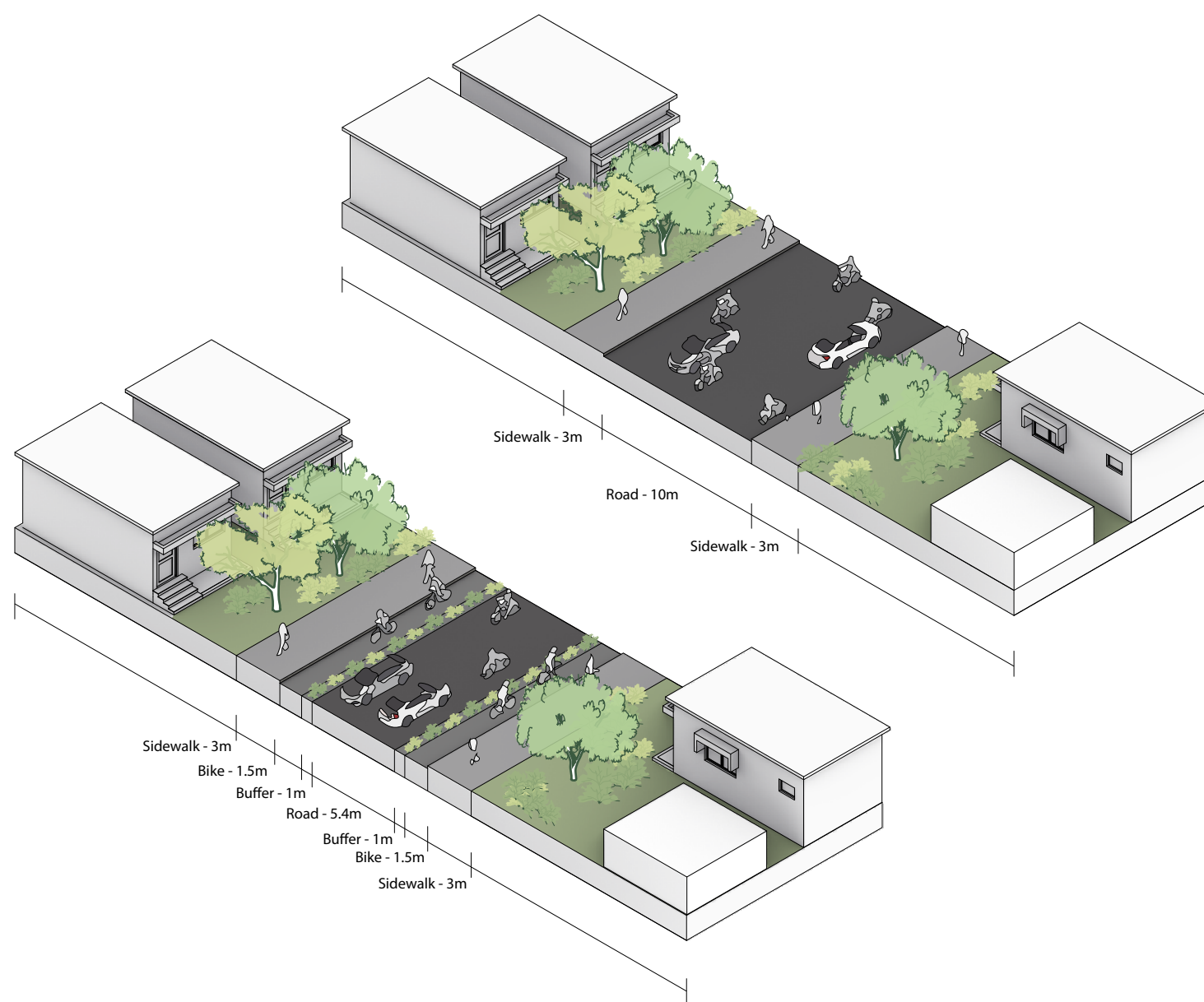

TPOLOGY 2: Local Street Bike Network

Decreasing the road size creates protected bike lanes on either side of the road with local flora serving as a buffer.

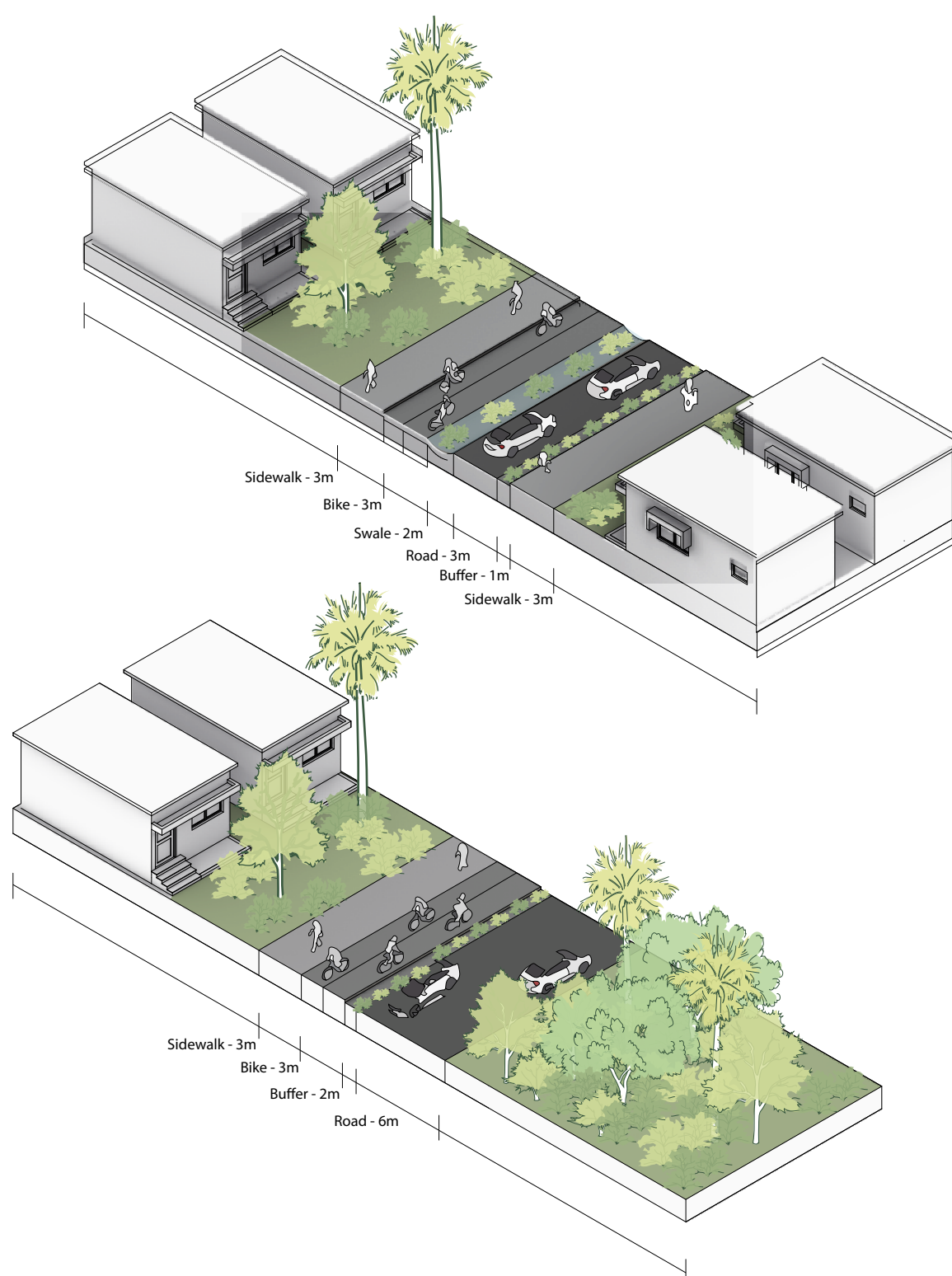

TPOLOGY 3: Urban Expansion Roads

(Above) With no precedence of existing road infrastructure, the wide spacing of the site yields a complete street design with features including a two way bike lane, bioswale, and one way traffic.

(Below) Along the urban expansion perimeter, a two way bike lane and green buffer is implemented to create a moment that coincides with the green armature.